

## Céliane™ WiFi Access Points

Cat. No(s): 673 66

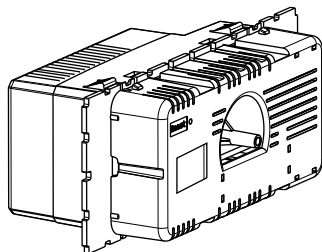

### CONTENTS

Page

|                                   |   |
|-----------------------------------|---|
| 1. Use.....                       | 1 |
| 2. Range.....                     | 1 |
| 3. Installation.....              | 1 |
| 4. Overall dimensions.....        | 1 |
| 5. Connection.....                | 2 |
| 6. General characteristics.....   | 2 |
| 7. Additional information.....    | 3 |
| 8. Web interface.....             | 3 |
| 9. Standards.....                 | 3 |
| 10. Conformity and approvals..... | 3 |
| 11. Accessories.....              | 3 |

### 1. USE

The WiFi access point enables any computer equipped with an 802.11b, 802.11g or 802.11a WiFi card to access a network without being connected to a socket. The data communication via WiFi between computers and the access point is encrypted using WEP, WPA or WPA2 (802.11i standard) protocols in order to avoid hacking and to limit access to the network to authorised computers only. The access point provides a maximum rate of 2 x 54 Mbps as per the 802.11g standard.

### 2. RANGE

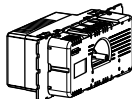
|   | Designation  | Nbr. of modules | Cat. No. | Weight (g) |
|---|--|-----------------|----------|------------|
|  | Dual-band WiFi access point 802.11a and 802.11 b/g | 5               | 673 66   | 105        |

### 3. INSTALLATION

The product is installed in a 50 mm deep Batibox box. The mechanism can be flush- or surface-mounted. The height at which the access point is installed in a wall does not influence the range and the data rate.

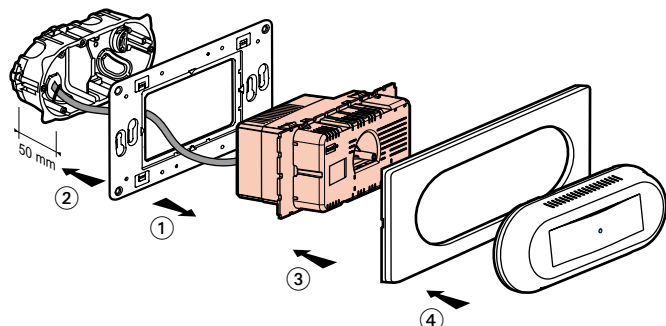

- 1- Clip the rear of the mechanism onto the support frame.
- 2- Screw the mechanism onto the flush-mounting box.
- 3- Clip the plate onto the mechanism.
- 4- Clip the rocker onto the plate.

### 4. OVERALL DIMENSIONS

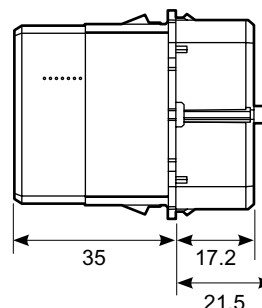
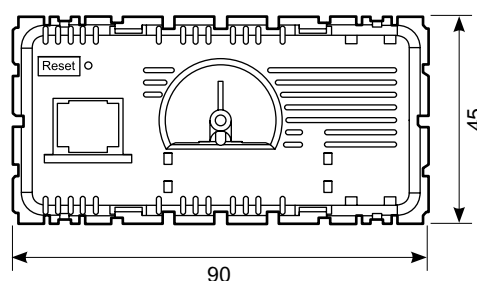

### 5. CONNECTION

Simply requires the installation of an Ethernet cable because its 48 V power supply is provided via this cable (PoE, 802.3af standard). Connection to the network cable (min. category 5) uses connection devices without tools, identically to other Legrand RJ45 sockets.

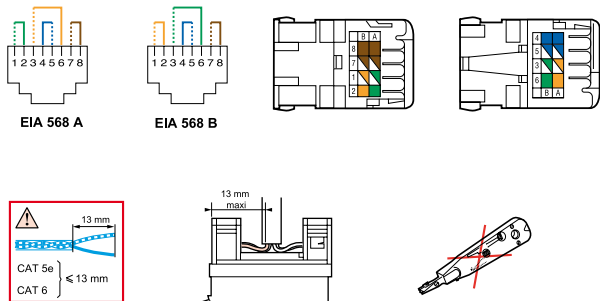

Connecting the cable is done without tools.

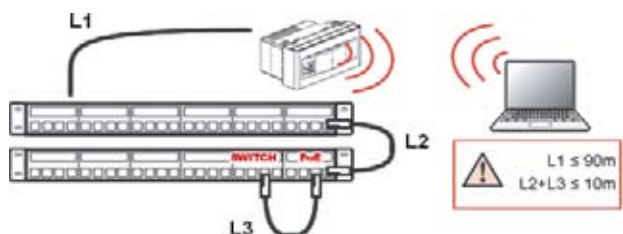

### 6. GENERAL CHARACTERISTICS

The configuration and administration of the access point can be done via an intuitive web interface. A quick configuration mode enables the administrator to configure the access point (WPA encryption) with a single click.

Automatic setting of date/time possible.

Backup/restoration of configuration.

Free update of firmware via the Legrand website.

A CD-Rom of tools is provided for configuration of the access point.

- **Number of antennas:** two built-in omnidirectional antennas.
- **Ethernet interface:** 10/100 Base T, RJ45, no-tool connection.
- **WiFi interface:** The access point allows simultaneous operation via 802.11 b/g 2.4 GHz and 802.11a 5 GHz.
- Built-in **RJ45 socket** (can be deactivated) with VLAN management
- **Communication frequencies** (channels) automatically adaptable to the country of use.
- **Frequency band:**
  - **802.11b/g:** 2.4 GHz ISM to 2.48 GHz ISM
  - **802.11a:** 5.15 GHz to 5.85 GHz UNII
- **Transmitting power** configurable (from 0 to 63 mW), to reduce or extend the coverage zone and increase the density of WiFi terminals.
- **Power supply:** PoE (Power over Ethernet).  
The 48 V power supply is carried by the Ethernet cable, 802.3af standard. Not supplied with the product.
- **UPnP:** Compatible.
- **SSID:** up to 12 SSIDs per access point.
- **Management of SNMPv1 and SNMPv2c, MIB-I, MIB-II, 802.11-MIB.**
- **Administration interface:** HTTP, HTTPS.
- Static or dynamic **IP addressing** (DHCP).
- **Authentication:** 802.1x (EAP TLS, EAP TTLS, PEAP).

### 6. GENERAL CHARACTERISTICS (cont.)

- **Encryption** (from least secure to most secure):

|                    |   |
|--------------------|---|
| <b>Open</b>        | No protection   |
| <b>Static WEP</b>  | Minimal protection level                                    |
| <b>WEP-802.1x</b>  | Also referred to as dynamic WEP, requires Radius server     |
| <b>WPA-PSK</b>     | (TKIP encryption)   |
| <b>WPA-802.1x</b>  | TKIP encryption, requires Radius server                     |
| <b>WPA2-PSK</b>    | Also called 802.11i, AES encryption                         |
| <b>WPA2-802.1x</b> | Also called 802.11i, AES encryption, requires Radius server |

Recommended minimum protection level: WPA-PSK

- **VLAN support** trunking 802.1q
- **VLAN allocation support** via SSID
- **Service class support** (WMM standard for MultiMedia WiFi), e.g. Voice over IP (VoIP)

#### 6.1 Material characteristics

- **Faceplate**  
White polycarbonate

#### 6.2 Climatic characteristics

- Operating temperature: +5 °C to +40 °C
- Storage temperature: 0 °C to +60 °C
- Maximum operation humidity: 85%
- Maximum storage humidity: 85%

#### 6.3 Electrical characteristics

- **Connector**  
Conductors supported:
  - Single-wire: 0.5 to 0.65 mm, AWG 24 to 22
  - Polyethylene conductor insulation: Ø max with insulation 1.5 mm.
 Number of wires to connect per connection: 1  
 Max number of connections and disconnections: 5 including 2 without refreshing the wire  
 Breakdown voltage: 1000 V  
 Contact resistance: 20 MOhms  
 Insulation resistance: 500 MOhms under 100 V DC

- **Faceplate**  
Self-extinguishing: 750 °C / 5 s

**Warning:** This product requires a PoE supply compliant with 802.3af standard (not supplied).

## 7. ADDITIONAL INFORMATION

Principle of rate reduction due to WiFi network management, sharing between users, distance and environment.

Example with 802.11g:

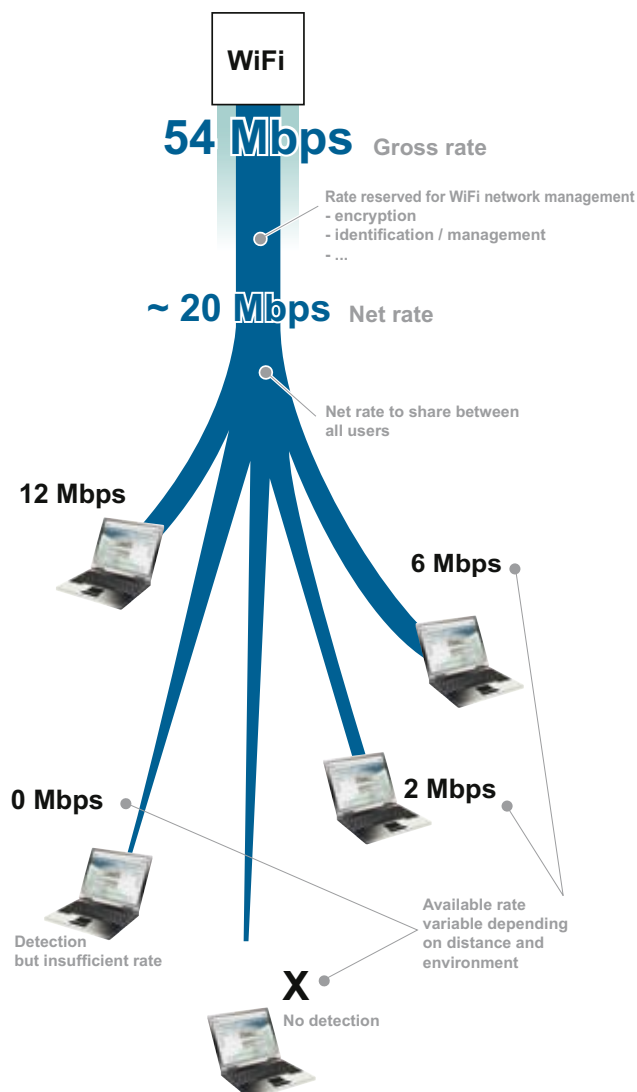

## 8. WEB INTERFACE

The access point has a web interface allowing intuitive administration of the access point as well as checking and management:

- radio (transmitting power), frequency (channel), (on/off),
- users connected,
- VLANs,
- IP addressing,
- the SSIDs (up to 12 per access point).
- encryption mode and corresponding passwords,
- administrator access,
- remote authentication via Radius server,
- authorised users,
- software updates (firmware).

## 9. STANDARDS

The access point is compatible with the following standards:

- **802.3af**: Power over Ethernet (PoE), supply via Ethernet cable.
- **802.11a**: Radio transmission standard
- **802.11b**: Radio transmission standard
- **802.11g**: Radio transmission standard
- **802.1x**: Identification standard (EAP TLS, EAP TTLS, PEAP).  
Identification is managed by a Radius server.
- **802.1q**: VLAN trunking
- **802.11i**: Data transfer encryption method also called WPA2.
- **WMM service class**: QoS support, e.g. for VoIP.

## 10. CONFORMITY AND APPROVALS

### DECLARATION OF COMPLIANCE

Nous déclarons que les produits satisfont aux dispositions de :  
 We declare that the products satisfy the provisions of :

**La Directive 1999/5/CE du Parlement européen  
 et du Conseil du 9 Mars 1999 "R & TTE"**

Sous réserve d'une utilisation conforme à sa destination  
 et / ou d'une installation conforme aux normes en vigueur  
 et / ou aux recommandations du constructeur

On condition that they are used in the manner  
 intended and/or in accordance with the current  
 installation standards and/or with the manufacturers  
 recommendations

La libération des canaux est sous la responsabilité de  
 chaque pays. L'administrateur réseaux sans fil doit configurer  
 le pays. Ainsi les canaux seront automatiquement  
 en conformité avec les dispositions du pays.

Channel availability depends on local country regulations.  
 Wireless LAN system administrator must choose correct  
 country of operation. Channels are then automatically  
 configured to comply with specified country's regulations.

Ces dispositions sont assurées pour la directive 1999/5/CE par la conformité aux normes suivantes:  
 These provisions are ensured for directive 1999/5/CEE by conformity to the following standards :

**EN 301 489-17**  
**EN 60669-2-1**  
**EN 60950**  
**EN 300 328**  
**EN 301 489-1**

## 11. ACCESSORIES

PoE (Power over Ethernet) injectors for electrical power supply

|        |  |
|--------|--|
| 327 37 | 1-port PoE injector to provide power to access point.      |
| 327 17 | 4-port PoE injector to provide power to two access points. |