

Céliane™ Multizone sound distribution system

Cat. Nos: 673 23/24/25

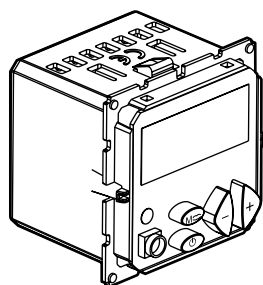

673 23

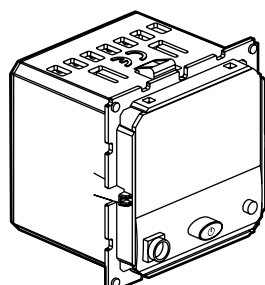

673 24

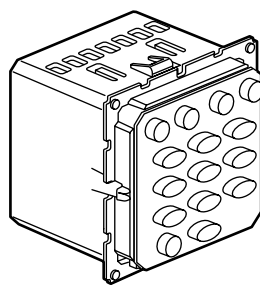

673 25

CONTENTS

Page

1. Use	1
2. Range	1
3. Overall dimensions	1
4. Fitting	2
5. Connection	2
6. Technical data	3
7. Cleaning	3
8. Conformity - Approvals	3
9. Accessories	3

1. USE

System that broadcasts a music source (hifi, MP3 player, etc.), general call and alarm clock functions.

Local broadcasting of source input sound.

Linking the tuner/intercom extension to a local control unit provides intercommunication and baby monitoring functions as well as local broadcasting of FM radio at a bandwidth between 87.5 and 108 MHz.

The local control unit has adjustable green backlighting.

2. RANGE

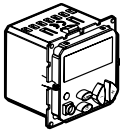
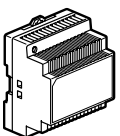
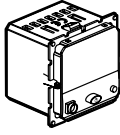
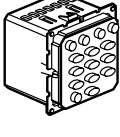
Designation	Cat. No	Fixing	Technical data	Weight (g)
	673 23	Claw/ screw	Input voltage (from the source): 15 V = Loudspeaker output: 1 x 1.5 W or 2 x 1.5 W Impedance: 4 ohms (compatible 8, 16 ohms) Auxiliary input: Ø 3.5-mm jack socket (via Ø 3.5-mm stereo jack lead, min. input level: 80 mV ms). Volume, balance and loudness control General call function Alarm clock function - beep or music Time display Programmable stop.	54
	673 24	Clipping onto DIN rail	Input voltage: 115-230 V~ - 50/60 Hz Output voltage: 15 V = Power: 60 W Dimensions: 4.5 modules	370
		Claw/ screw	Input voltage: 15 V Connects to the source via a Ø 3.5-mm stereo jack socket (min. input level: 80 mV ms). Central button: system standby.	
	673 25	Claw/ screw	Extension unit for the local control unit. Connection via a flexible flat cable (supplied) FM bandwidth from 87.5 to 108 MHz Antenna wire supplied. Intercom: zone and/ or group and/or baby monitoring function. Programmable stop. system standby.	37

3. OVERALL DIMENSIONS

673 23

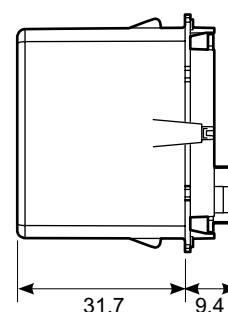
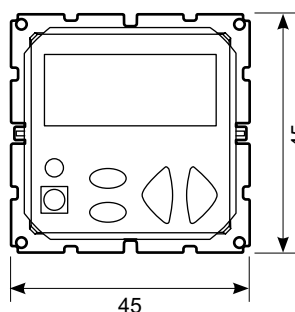

673 24

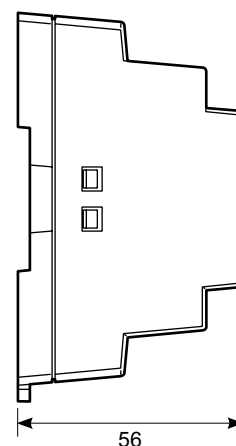
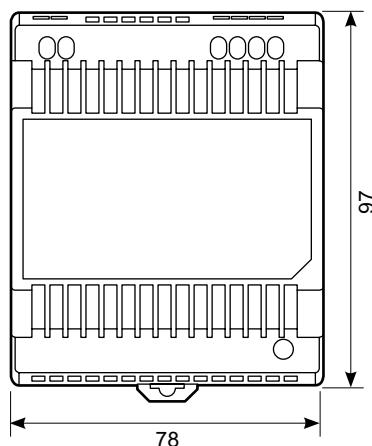
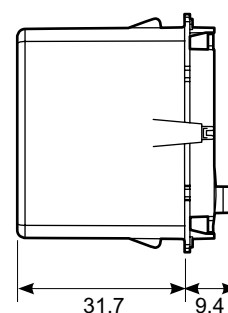
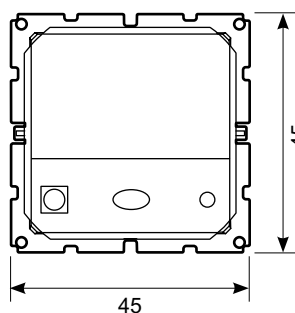

Céliane™ Multizone sound distribution system

Cat. Nos: 673 23/24/25

3. OVERALL DIMENSIONS (cont'd)

673 25

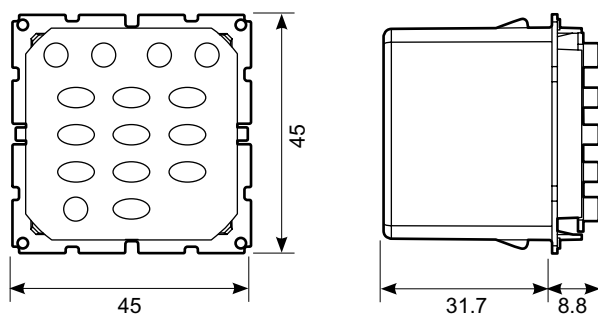

4. FITTING

Example: Cat. No 673 23

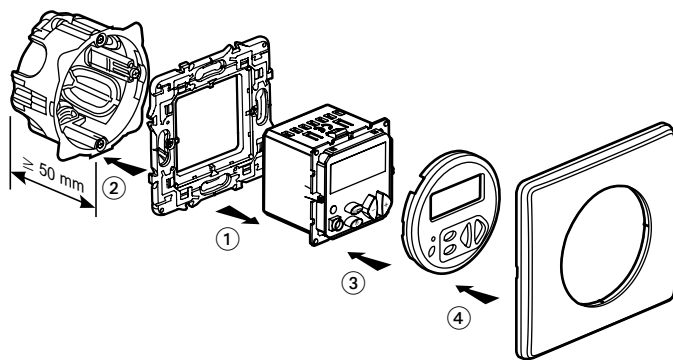

- 1 - The mechanisms are clipped to the support frame from the front.
- 2 - The mechanism/support frame assembly is screwed to the flush-mounting box.
- 3 - The cover plate is clipped to the mechanism.
- 4 - The frame plate is clipped to the support frame.

Example: Cat. No 673 23 and 673 24

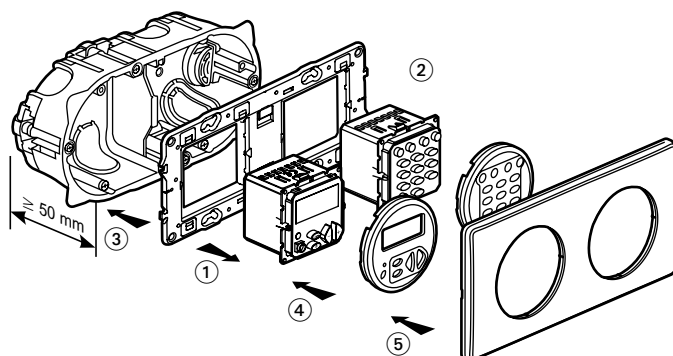

- 1 - The mechanisms are clipped to the support frame from the front.
- 2 - The flat cable is connected between the products (flat cable length about 13 cm)
- 3 - The mechanism/support frame assembly is screwed to the flush-mounting box.
- 4 - The cover plates are clipped to the mechanisms.
- 5 - The frame plate is clipped to the support frame.

Can be fitted with the full range of Céliane finishings.
Vertical and horizontal multi-gang mounting.

4. FITTING (cont'd)

Mounting centre distances:

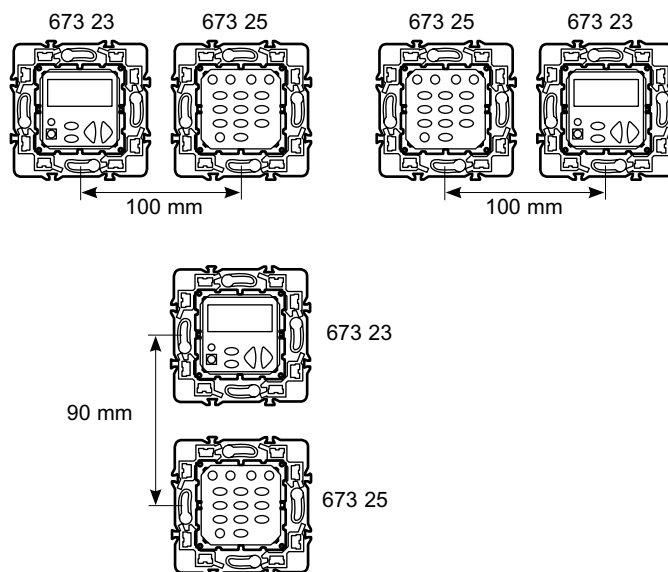

4.1 Dismantling

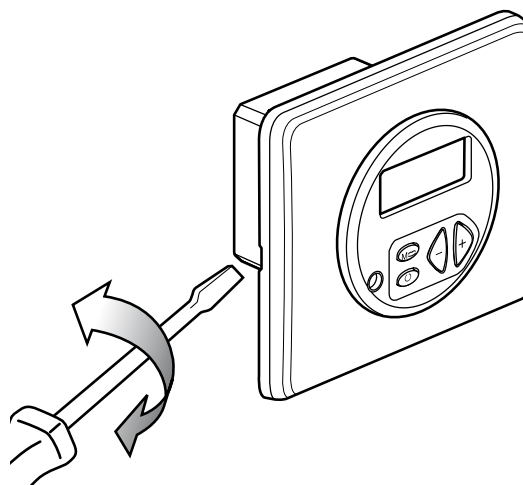

5. CONNECTION

5.1 Option of connecting a FM antenna to the tuner/Intercom extension 673 25 using a wire with cross-section 2.5 mm²

	673 24		673 23	673 25
	Power supply 230 V	Source input 15 V	Local control unit	Tuner/intercom extension
Type of screwdriver	Flat-blade (3 mm)	Flat-blade (3 mm)	Flat-blade (3 mm)	Flat-blade (3 mm)
Type of terminal	Tunnel	Tunnel	Tunnel	Tunnel
Power supply wires - cross-section (mm²)	Min.: 1.5 Max.: 4	Min.: 1.5 Max.: 2.5	Min.: 1.5 Max.: 2.5	/
Loudspeaker wires - cross-section (mm²)	/	/	Min.: 0.25 Max.: 1	/

Multizone sound distribution system

5. CONNECTION (cont'd)

5.2 Distance (in m) between the source input and the last product according to wire cross-section

- data 0.9 mm²
- power supply ≥ 1 mm²

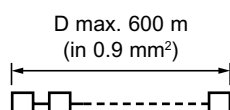

5.3 Cabling 2 power supplies

If an installation exceeds the permissible power of the power supply (60 W), extra power supplies can be added by following the cabling system illustrated below:

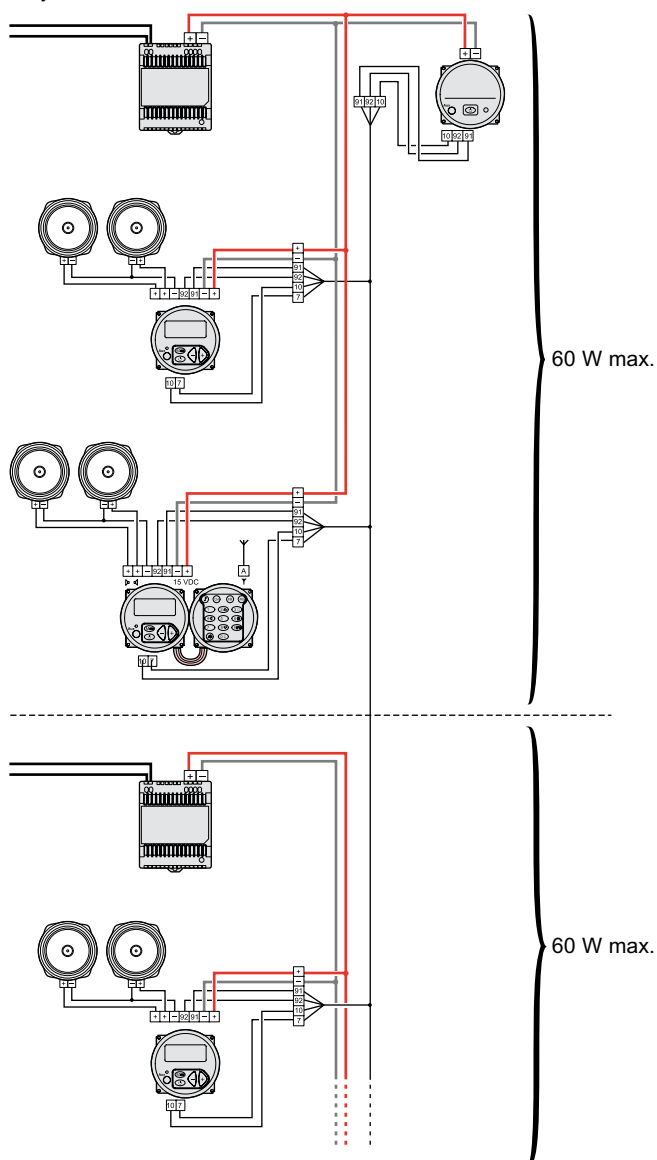

6. TECHNICAL DATA

6.1 Mechanical characteristics

- Flush-mounting products (with cover plate):
Impact tests: IK 02 (except 673 23)
Penetration by solid/liquid bodies: IP 21
- Power supply:
Penetration by solid/liquid bodies: IP 20

6. TECHNICAL DATA (cont'd)

6.2 Material characteristics

Mechanism:

	673 24		673 23	673 25
	Power supply 230 V	Source input 15 V	Local control unit	Tuner/intercom extension
Base	Polycarbonate Pantone Coolgray 2C	Polycarbonate RAL 7016	Polycarbonate RAL 7016	Polycarbonate RAL 7016
Keys	/	Silicone RAL 7038	Silicone RAL 7038	Silicone RAL 7038

6.3 Electrical characteristics

Self-extinguishing - Live parts: 850° C / 30 s, others 650° C / 30 s.
Consumption (in W):

	Stereo		Mono	
	Normal	Max.	Normal	Max.
673 23	2.1	4.4	1.7	2.8
673 23 + 673 25	2.8	5.3	2.2	3.4
673 24	1.5	1.5	1.5	1.5

6.4 Climatic characteristics

Storage temperature: from - 25° C to + 70° C
Operating temperature: from - 5° C to + 45° C

7. CLEANING

No cleaning.

8. CONFORMITY - APPROVALS

Compliant with standard 50090-2-2

9. ACCESSORIES

	Designation	Cat. No	Fixing	Technical data
	Loudspeaker socket	673 11	Claws / screws	Connection of loudspeakers with any impedance
	2" loudspeakers (Ø 80 mm) Spot type	673 27	Strips Springs	2 W - 16 Ohms White
	Wall-mounting 2" loudspeakers	673 28	Fits into flush-mounting boxes	2 W - 16 Ohms
	Hidden loudspeaker	673 29	Lugs	100 W - 8 Ohms White
	Hidden loudspeaker	673 30	Lugs	8 W - depth 98 mm